

10 216 3KF 0D **ESSENCE SINGLE-LEVER SINK MIXER 1/2"**

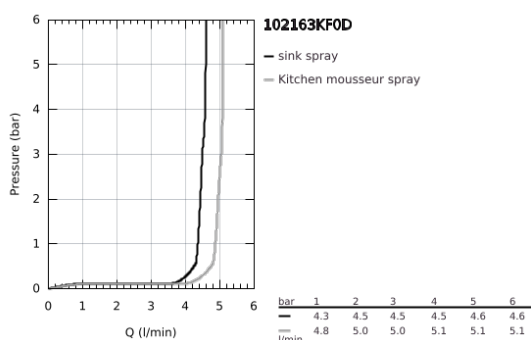
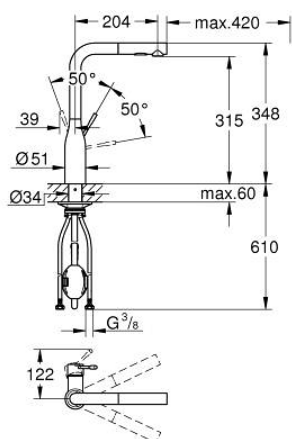

PRODUCT DESCRIPTION

- Colour: phantom black
- flow rate 5.67 l/min
- high spout
- single hole installation
- GROHE Long-Life finish
- GROHE SilkMove 28 mm ceramic cartridge
- flow straightener
- pull-out dual spray - switches back and forth between regular flow and spray
- diverter: laminar spray/SpeedClean shower jet
- automatic return to laminar spray
- metal spray
- swivel tubular spout
- swivel area 360°
- integrated non-return valve
- protected against backflow
- flexible connection hoses
- integrated temperature limiter
- maximum flow rate (at 3 bar): 5 l/min
- min. recommended pressure 1.0 bar
- professional edition

10 216 3KF 0D **ESSENCE SINGLE-LEVER SINK MIXER 1/2"**

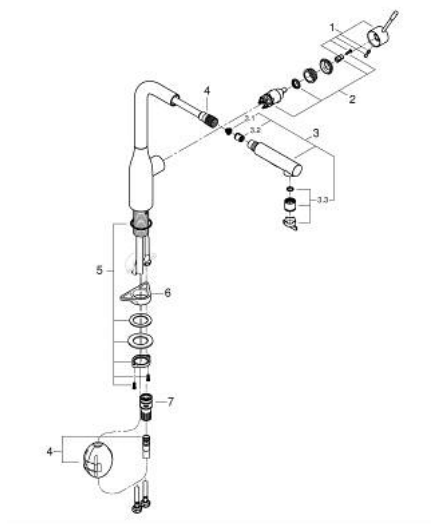

SPARE PARTS, February 2023 – now

- 1: lever (Spare part-nr. 46927KF0)
- 2: Cartridge (Spare part-nr. 46580000)
- 3: Pull out spray (Spare part-nr. 46926KF0)
- 3.1: Dirt strainer (Spare part-nr. 0676800M)
- 3.2: Non-return valve (Spare part-nr. 08565000)
- 3.3: Flow straightener (Spare part-nr. 48275000)
- 4: Hose for sink mixer with pull-out dual spray or mousseur (Spare part-nr. 48293000)
- 5: Shank fastening assembly (Spare part-nr. 48384000)
- 6: Support plate (Spare part-nr. 05334000)
- 7: Quick coupling (Spare part-nr. 64999000)