

19 364 LS0 VERIS THERMOSTAT WITH INTEGRATED 2-WAY DIVERTER FOR BATH OR SHOWER WITH MORE THAN ONE OUTLET



PRODUCT DESCRIPTION

- Colour: moon white
- set for final installation for
- GROHE Rapido T 35 500 000
- without concealed body
- GROHE Long-Life finish
- GROHE SafeStop Plus integrated temperature limiter at max 50°C
- Aquadimmer with multiple function
- shut off and flow control
- diverter for 2 outlets
- metal handles
- wall escutcheon with GROHE FastFixation (covered escutcheon- and shaft sealing, covered fixing)
- metal escutcheon
- ** KS0 and LS0 can be ordered (minimum quantity 100 pcs). Delivery time minimum 12 weeks.

19 364 LS0 VERIS THERMOSTAT WITH INTEGRATED 2-WAY DIVERTER FOR BATH OR SHOWER WITH MORE THAN ONE OUTLET

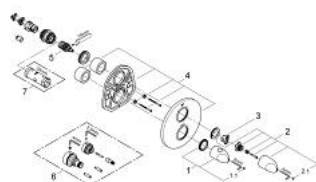

SPARE PARTS, November 2009 – spareParts.validDate.now

1: Scale handle, metallic (Order-nr. 47729LS0)

1.1: Cover cap (Order-nr. 47818LSM)

2: Shut-off handle Aquadimmer (Order-nr. 47814LS0)

2.1: Cover cap (Order-nr. 47818LSM)

3: Stop ring (Order-nr. 10089000)

4: Escutcheon (Order-nr. 47816LS0)

5: Aquadimmer (Order-nr. 47364000)

6: Extension-set 27.5 mm (Order-nr. 47781000)*

7: Socket Spanner (Order-nr. 19332000)*

* Optional accessories