

20 404 001 **COSTA L PILLAR TAP 1/2"**

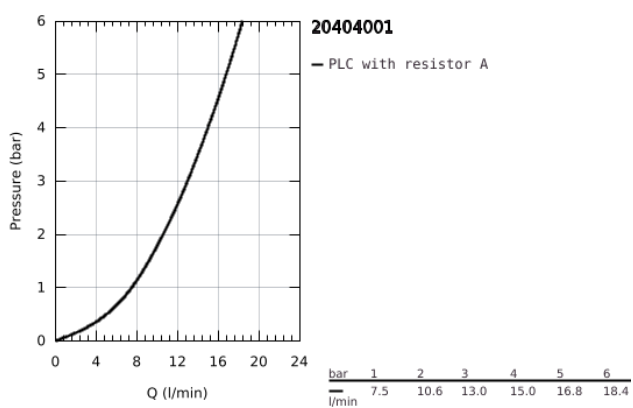

PRODUCT DESCRIPTION

- Colour: chrome
- metal handle
- heat-insulated
- screwable
- marking: blue
- GROHE Long-Life headpart
- cast spout with mousseur
- union nut 1/2" with 10.5 mm drilling
- GROHE Long-Life finish

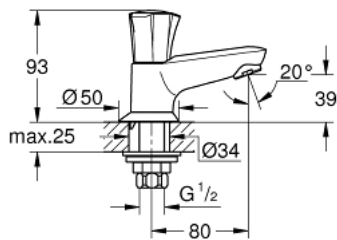

20 404 001 **COSTA L PILLAR TAP 1/2"**

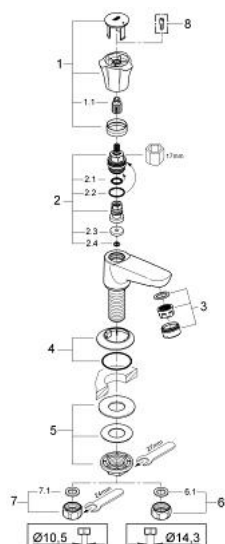

SPARE PARTS, June 2007 – spareParts.validDate.now

- 1: Handle (Order-nr. 45994000)
 - 1.1: Snap insert (Order-nr. 0538600M)
 - 2: Headpart 1/2" (Order-nr. 07146000)
 - 2.1: Sealing washer Ø 6 x Ø 2 (Order-nr. 0128300M)
 - 2.2: O-ring Ø 18.2 x Ø 1.7 (Order-nr. 0392400M)
 - 2.3: Seal (Order-nr. 0529100M)
 - 3: Mousseur (Order-nr. 13929000)
 - 4: Escutcheon (Order-nr. 45996000)
 - 5: Shank fastening assembly (Order-nr. 45004000)
 - 6: Coupling nut 1/2" x 14.5 mm (Order-nr. 1290200M)
 - 6.1: Fibre seal dia. Ø 18,5 x Ø 12 x 2 (Order-nr. 0138900M)
 - 7: Coupling nut 1/2" (Order-nr. 1290100M)
 - 7.1: Fibre seal dia. Ø 18,5 x Ø 12 x 2 (Order-nr. 0138900M)
 - 8: Screw for Costa/Avina products (Order-nr. 48013000)*
- * Optional accessories