

## 20 422 000 BAULoop PILLAR TAP 1/2" XS-SIZE

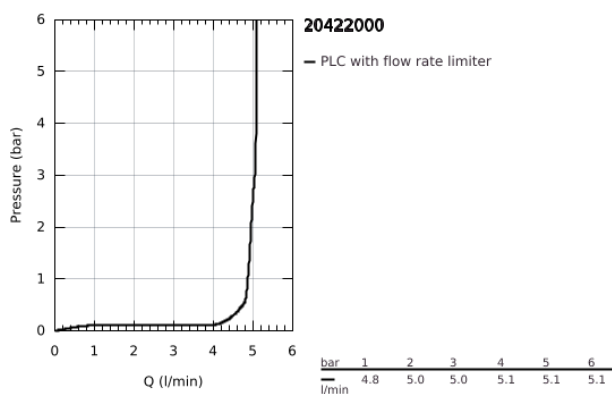

### PRODUCT DESCRIPTION

- Colour: chrome
- single hole installation
- metal lever
- ceramic headpart 1/2", 90°
- GROHE Long-Life finish
- GROHE Water Saving - Less water, perfect flow
- maximum flow rate (at 3 bar): 5 l/min
- fixation nut G 1/2"

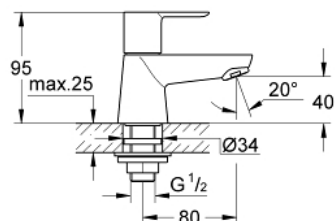

## 20 422 000 **BAULOO PILLAR TAP 1/2" XS-SIZE**

### **SPARE PARTS**, September 2012 – now

1: Lever (Spare part-nr. 48027000)

2: Ceramic headpart, 1/2" (Spare part-nr. 45882000)

2.1: O-ring Ø 18.2 x Ø 1.7 (Spare part-nr. 0392400M)

3: Mousseur (Spare part-nr. 13952000)

4: Shank fastening assembly (Spare part-nr. 45004000)

