

24 060 003 **GROHE PLUS SINGLE-LEVER MIXER WITH 2-WAY DIVERTER**

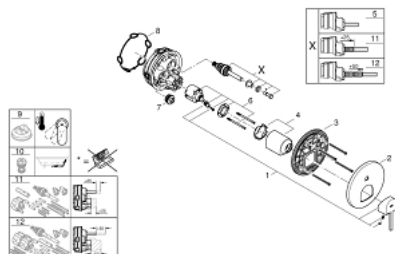

SPARE PARTS, August 2018 – now

- 1: lever (Spare part-nr. 48496000)
- 2: escutcheon (Spare part-nr. 49118000)
- 3: Mounting plate (Spare part-nr. 48438000)
- 4: cap (Spare part-nr. 48495000)
- 5: Diverter (Spare part-nr. 48442000)
- 6: Cartridge (Spare part-nr. 46048000)
- 7: Non-return valve (Spare part-nr. 49085000)
- 8: Seal (Spare part-nr. 48360000)
- 9: Temperature limiter (Spare part-nr. 46375000)*
- 10: Backflow protection combination (EN1717) (Spare part-nr. 14055000)*
- 11: Universal extension set single-lever mixers, 25 mm (Spare part-nr. 1405600)*
- 12: Universal extension set single-lever mixers, 50 mm (Spare part-nr. 14057000)*
- * Optional accessories

24 060 003 **GROHE PLUS SINGLE-LEVER MIXER WITH 2-WAY DIVERTER**



SPARE PARTS, August 2018 – now

- 1: Lever (Spare part-nr. 48496000)
 - 2: Escutcheon (Spare part-nr. 49118000)
 - 3: Mounting plate (Spare part-nr. 48438000)
 - 4: Cap (Spare part-nr. 48495000)
 - 5: Diverter (Spare part-nr. 48442000)
 - 6: Cartridge (Spare part-nr. 46048000)
 - 7: Non-return valve (Spare part-nr. 49085000)
 - 8: Seal (Spare part-nr. 48360000)
 - 9: Temperature limiter (Spare part-nr. 46375000)*
 - 10: Backflow protection combination (EN1717) (Spare part-nr. 14055000)*
 - 11: Universal extension set single-lever mixers, 25 mm (Spare part-nr. 14056000)*
 - 12: Diverter (Spare part-nr. 48444000)*
 - 13: Universal extension set single-lever mixers, 50 mm (Spare part-nr. 14057000)*
 - 14: Diverter (Spare part-nr. 48445000)*
- * Optional accessories