

26 507 DC0 EUPHORIA SMARTCONTROL SYSTEM 310 DUO SHOWER SYSTEM WITH THERMOSTAT FOR WALL MOUNTING

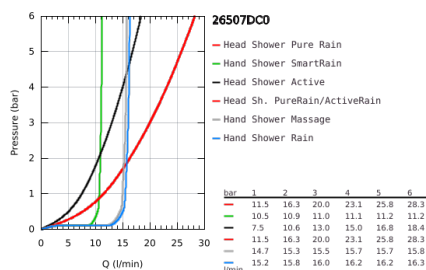
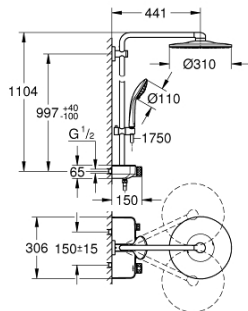

PRODUCT DESCRIPTION

- Colour: Supersteel
- consisting of:
 - horizontal 450 mm shower arm
 - upper bracket adjustable for minimal adaption to existing drilling holes
 - exposed SmartControl thermostat
 - allows change between:
 - head shower Rainshower SmartActive 310
 - 2 spray patterns:
 - GROHE PureRain, ActiveRain
 - hand shower Euphoria 110 Massage, spray plate white
 - 3 spray patterns:
 - Rain, SmartRain, Massage
 - adjustable in height with gliding element
 - Silverflex shower hose 1750 mm (28 388 000)
 - GROHE DreamSpray perfect spray pattern
 - GROHE Long-Life finish
 - GROHE CoolTouch no risk of scalding
 - GROHE TurboStat compact cartridge with wax thermoelement
 - GROHE ProGrip with knurl structure
 - GROHE Water Saving - Less water, perfect flow
 - - GROHE SafeStop at 38°C
 - GROHE SafeStop Plus optional temperature limiter at 43°C included
 - GROHE SmartControl push for ON-OFF, turn for volume adjustment from GROHE Water Saving to full flow
 - integrated GROHE EasyReach shower tray
 - SpeedClean anti-lime system
 - Inner WaterGuide for a longer life
 - TwistStop to prevent hose from twisting
 - suitable for instantaneous heaters from 18 kW/h
 - minimum flow rate 7 l/min.

26 507 DC0 EUPHORIA SMARTCONTROL SYSTEM 310 DUO SHOWER SYSTEM WITH THERMOSTAT FOR WALL MOUNTING

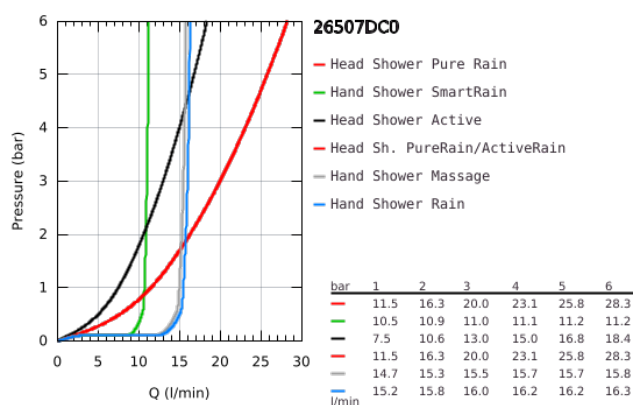

26 507 DC0 EUPHORIA SMARTCONTROL SYSTEM 310 DUO SHOWER SYSTEM WITH THERMOSTAT FOR WALL MOUNTING



SPARE PARTS, July 2018 – spareParts.validDate.now

- 1: Thermostatic compact cartridge 1/2" (Order-nr. 47439000)
- 2: Cartridge (Order-nr. 48297000)
- 3: Non-return valve (Order-nr. 49069000)
- 4: Non-return valve (Order-nr. 08565000)
- 5: Glide element (Order-nr. 48177DC0)
- 6: Dirt strainer (Order-nr. 0700200M)
- 7: Shower bar holder (Order-nr. 48279DC0)
- 9: GROHE TurboStat cartridge 1/2" (Order-nr. 47175000)*
- 10: Socket Spanner (Order-nr. 49059000)*

* Optional accessories