

## 27 472 000 RAINSHOWER SYSTEM VERIS 300 SHOWER SYSTEM WITH THERMOSTAT FOR WALL MOUNTING

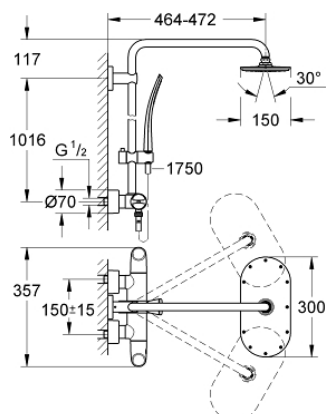

### PRODUCT DESCRIPTION

- Colour: chrome
- consisting of:
  - horizontal swivable 450 mm shower arm
  - exposed thermostat with Aquadimmer function
  - allows change between:
    - head shower Rainshower 310
    - with ball joint
    - rotation angle  $\pm 15^\circ$
  - hand shower GROHE Ondus (27 185 000)
  - adjustable in height with gliding element (12 140 000)
  - metal shower hose 1750 mm (28 025)
- GROHE Water Saving 9.5 l/min flow limiter
- GROHE TurboStat compact cartridge with wax thermoelement
- GROHE SafeStop at 38°C
- GROHE SafeStop Plus optional temperature limiter at 43°C included
- GROHE CoolTouch
- GROHE DreamSpray perfect spray pattern
- GROHE Long-Life finish
- SpeedClean anti-lime system
- Inner WaterGuide for a longer life
- suitable for instantaneous heaters from 18 kW/h
- minimum flow rate 7 l/min.



## 27 472 000 RAINSHOWER SYSTEM VERIS 300 SHOWER SYSTEM WITH THERMOSTAT FOR WALL MOUNTING



### SPARE PARTS, June 2013 – spareParts.validDate.now

- 1: Shut-off handle Aquadimmer (Order-nr. 47814000)
  - 1.1: Cover cap (Order-nr. 4781800M)
  - 2: Stop (Order-nr. 47723000)
  - 3: Aquadimmer (Order-nr. 47364000)
  - 4: Water flow (Order-nr. 47887000)
  - 5: Scale handle, metallic (Order-nr. 47729000)
  - 5.1: Cover cap (Order-nr. 4781800M)
  - 6: Fitting ring (Order-nr. 47743000)
  - 7: Thermostatic compact cartridge 1/2" (Order-nr. 47439000)
  - 8: Non-return valve (Order-nr. 47189000)
  - 8.1: Dirt Strainer (Order-nr. 0726400M)
  - 8.2: Non-return valve (Order-nr. 08565000)
  - 8.3: O-ring  $\varnothing 17 \times \varnothing 2$  (Order-nr. 0305500M)
  - 9: S-union (Order-nr. 12693000)
  - 10: Non-return valve (Order-nr. 08565000)
  - 11: Glide element (Order-nr. 12140000)
  - 12: Dirt strainer (Order-nr. 0700200M)
  - 13: Fibre seal dia.  $\varnothing 18,5 \times \varnothing 12 \times 2$  (Order-nr. 0138900M)
  - 14: Dirt strainer (Order-nr. 48007000)
  - 15: Compensation disc (Order-nr. 27180000)\*
  - 16: Socket Spanner (Order-nr. 19332000)\*
  - 17: Thermo-element 1/2" for changed waterways (Order-nr. 47175000)\*
  - 18: Special spanner (Order-nr. 19377000)\*
  - 19: Shower system pipe for retrofitting (Order-nr. 48053000)\*
  - 20: Shower system pipe for retrofitting (Order-nr. 48054000)\*
- \* Optional accessories