

38 661 000 FLUSHING CISTERN GD 2

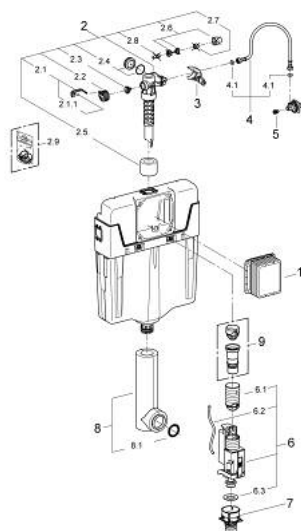

SPARE PARTS, November 2012 – now

- 1: Inspection shaft (Spare part-nr. 66783000)
- 2: Filling valve (Spare part-nr. 37095000)
- 2.1: Lever (Spare part-nr. 43734000)
- 2.1.1: Seal (Spare part-nr. 4377000M)
- 2.2: Valve head (Spare part-nr. 43536000)
- 2.3: Membrane (Spare part-nr. 4375800M)
- 2.4: Screw cap (Spare part-nr. 43735000)
- 2.5: Valve FLOAT, 5 pcs. (Spare part-nr. 4379100M)
- 2.6: Set of seals (Spare part-nr. 43722000)*
- 3: Support device (Spare part-nr. 42246000)
- 4: Tube (Spare part-nr. 42233000)
- 4.1: Sealing washer (Spare part-nr. 0319100M)
- 5: Headpart (Spare part-nr. 42385000)
- 6: AV1 complete with pipe extension (Spare part-nr. 42320000)
- 6.1: extension for Overflow pipe (Spare part-nr. 42313000)
- 6.2: Pneumatic hose (Spare part-nr. 42319000)
- 6.3: Seal (Spare part-nr. 42310000)
- 7: Valve seat for GD2 (Spare part-nr. 42315000)
- 8: Flush pipe, concealed (Spare part-nr. 43908000)
- 8.1: Sealing washer (Spare part-nr. 4388000M)
- 9: 4.5 l adapter for GD2 (Spare part-nr. 42333000)*

* Optional accessories